

- ☑ Kordon installed to brickwork, where a sill tile/brick/half brick is secured on top of Kordon.
- ☑ These tiles etc may move, or be displaced, in particular when the vertical face of the sill is minimal, thus not allowing much room for the sand and cement bed to be placed before installing the sill tile.
- ☑ The superseded installation detail kd052 will "deter concealed termite access" however it appears that in some cases, the detail is being misinterpreted, with the product in some instances being removed completely off the sill, which is not acceptable. The tilers / bricklayers have to be aware of the necessity for the barrier not to be tampered with.
- ☑ Kordon is to be secured to the brickwork and only installed off the external brick line if the face brickwork is to be raked.
- ☑ This installation will provide an effective barrier.

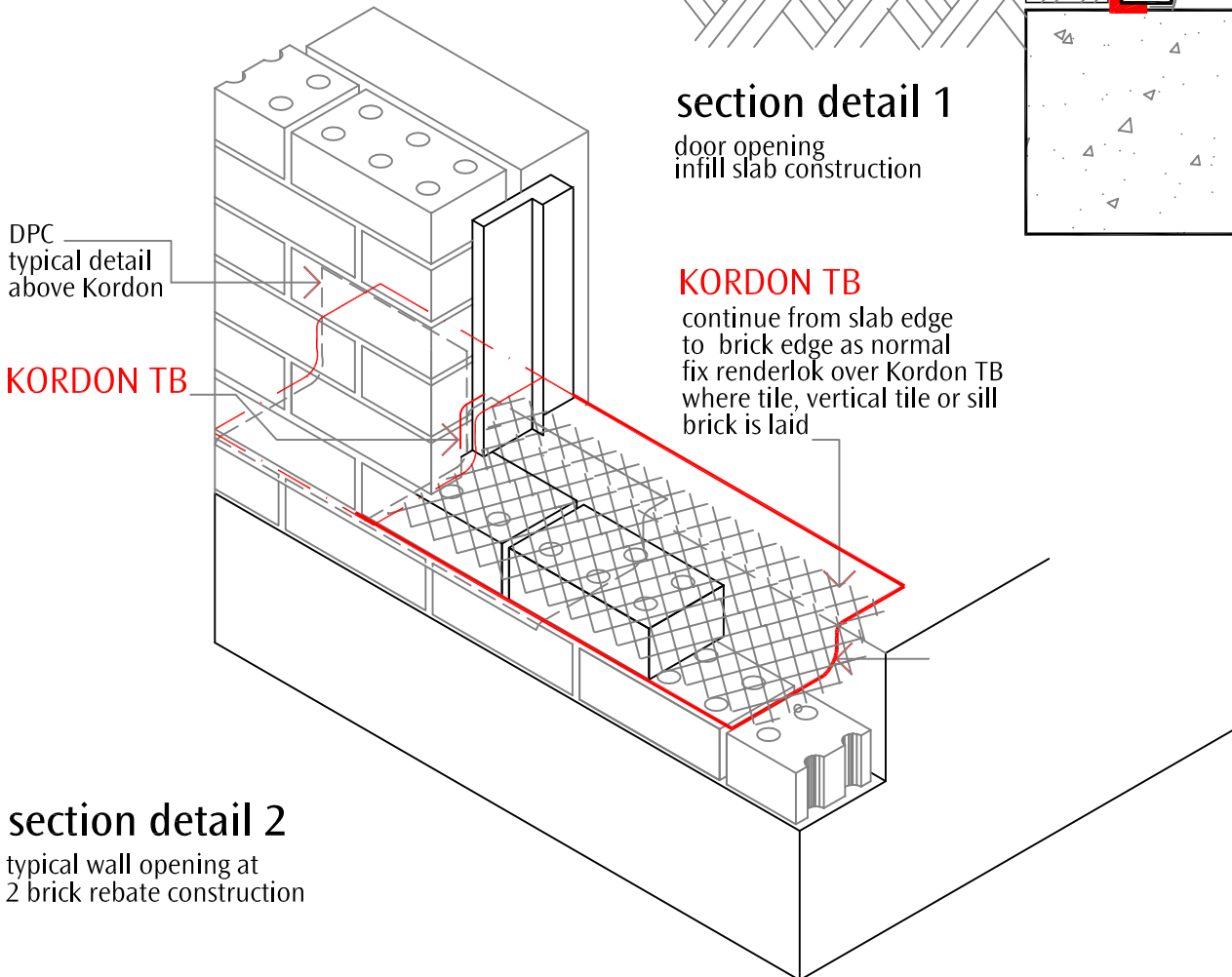
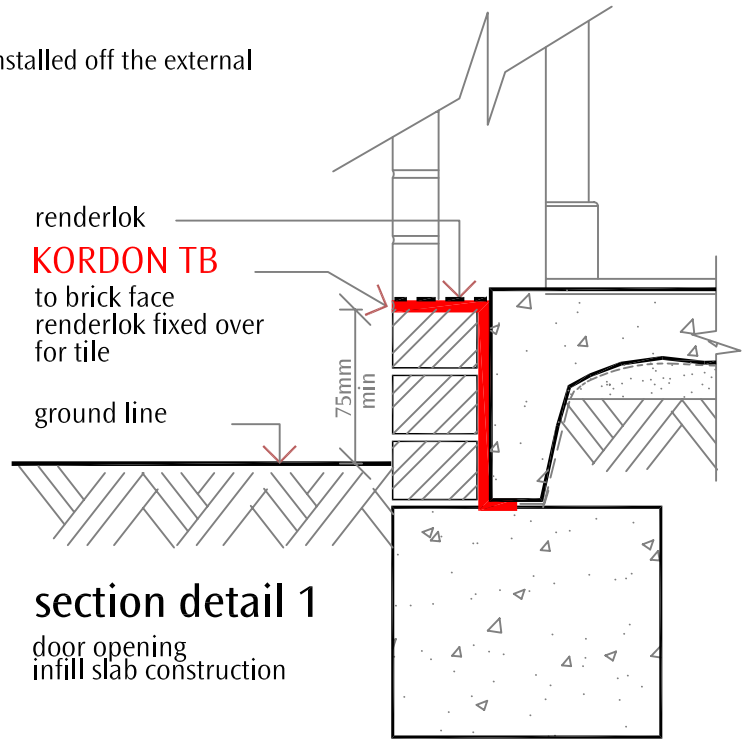

## KORDON TERMITE BARRIER

Subject

door / sill - detail 1

Sheet No.

**kd 048b**